

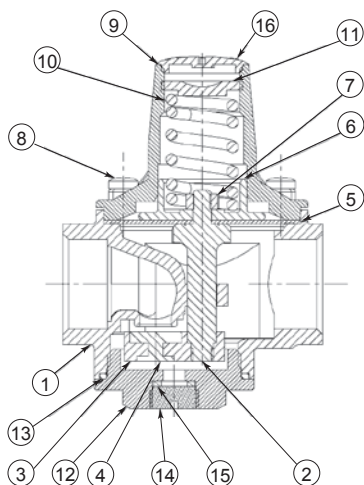

Type 7BIS

Features

- Control and maintain the downstream pressure at an adjustable reduced value, whether there is a flow or not.
- Keep an outlet pressure at a constant value, even by variation of the upstream pressure (the downstream pressure cannot vary more than 10% of the variation of the upstream pressure, according to the Standard).
- No maintenance required, not affected by scale or dirt.
- Can be installed in any position.
- Guarantee a high flow rate at a constant outlet pressure because of low head loss.
- Work as pressure reducing valve (standard terminology) as well as "regulator" and as "pressure regulating value" (when applies for gas).
- Adjustable : supplied pre-set at 3 bar.
- Equipped with 2 plugs 1/4" on each side to allow the mounting of downstream pressure gauge and drain.



Overall dimensions

DN		15	20	25	32	40	50
D	Inch	1/2	3/4	1	1 1/4	1 1/2	2
	mm	15/21	20/27	26/34	33/42	40/49	50/60
A	mm	30	33	30	34.5	36.5	45.5
B	mm	56	61	68	91	106	106
C	mm	64.5	72	81	97	110	135
G	mm	50	57	70	81	92	120
Wg.	kg	0.5	0.6	0.95	1.55	2.05	3.70

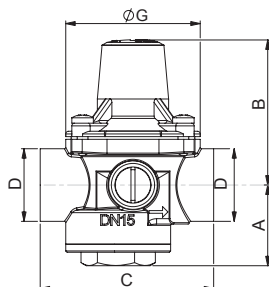

Spare parts list and materials

Nb	Description	Material
1	Casing	Bronze
2	Stem	DZR brass
3	Seal box	Brass
4	Seal	NBR (Nitrile)
5	Membrane	NBR/Polyamide
6	Membrane washer	Brass
7	Nut	Stainless steel
8	Screw	Stainless steel
9	Cap	Brass
10	Spring	Anticorrosive steel
11	Adjusting screw	Brass
12	Cap cover	Brass
13	O-Ring	NBR (Nitrile)
14	Pressure gauge cap	Brass
15	Flat ring	NBR (Nitrile)
16	Plug	Plastic

Technical description

- **Connection** : female/female, BSP thread
- **Downstream pressure gauge** : 1/4"
- **Permissible operating pressure**
PFA - water : See table
- **Maximum permissible pressure**
PS - other medium : See table
- **2 plugs 1/4" on each side for downstream pressure gauge : 1/4"**
- **T°** : Mini. -10°C
Maxi. in permanent service 80°C (40°C domestic fuel oil)
- **Mediums** : water, air-neutral gas, domestic fuel oil
- **Approvals** : ACS (France)
- **International construction**
Standards :
Pressure reducing valves EN 1567 /
Threaded connec. NF EN ISO 228

Technical table

DN		PFA (bar)	PS (bar)				Cat.	References
“	mm		L1	L2	G1	G2		
1/2	15	16	16	16	X	16	3.3	149B7209
3/4	20	16	16	16	X	16	3.3	149B7210
1	25	16	16	16	X	16	3.3	149B7552
1¼	32	16	16	16	X	16	3.3	149B7553
1½	40	16	16	16	X	16	3.3	149B7554
2	50	16	16	16	X	16	3.3	149B7555

L1, L2, G1, G2 correspond to liquids/gas classified into degree of danger according to the Pressure Equipment Directive (PED).
The article 3.3 applies to equipments with no CE marking.

Pressure setting range

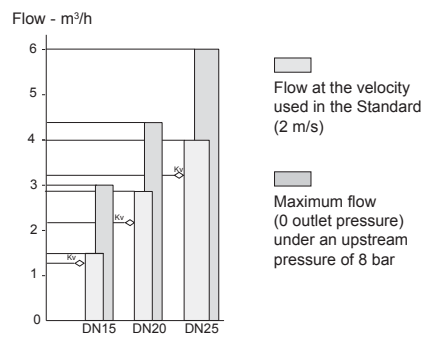
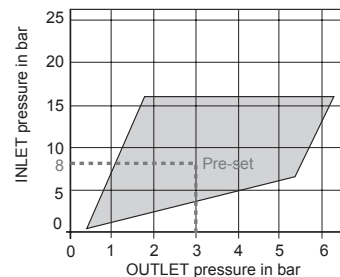

*last updated 03/16





Type 11BIS

Features

- Keep an outlet pressure at a constant value, even by variation of the upstream pressure (the downstream pressure cannot vary more than 10% of the variation of the upstream pressure, according to the Standard).
- No maintenance required, not affected by scale or dirt.
- Can be installed in any position.
- Guarantee a high flow rate at a constant outlet pressure because of low head loss.
- Work as pressure reducing valve (standard terminology) as well as "regulator" and as "pressure regulating valve" (when applies for gas).
- Adjustable : supplied pre-set at 3 bar.

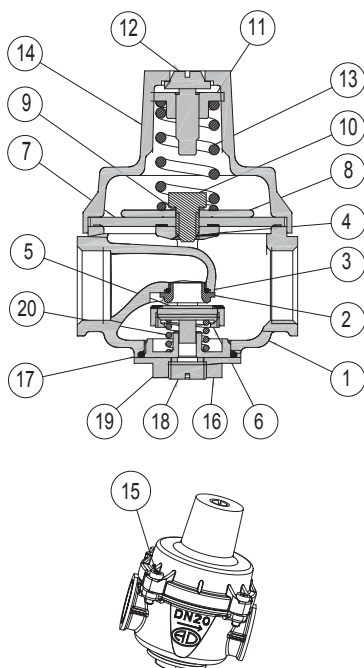

Overall dimensions							
DN		PFA	PS bar				Cat.
mm	inch	bar	L1	L2	G1	G2	
15	1/2	25	25	25	x	25	3.3
20	3/4	25	25	25	x	25	3.3
25	1	25	25	25	x	25	3.3
32	1 1/4	25	25	25	x	25	3.3
40	1 1/2	25	25	25	x	25	3.3
50	2	25	25	25	x	25	3.3

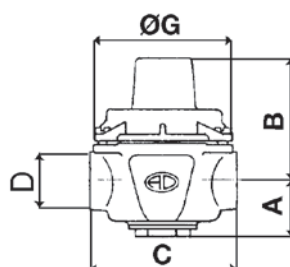

Spare parts list and materials

Nb	Description	Material
1	Casing	Bronze
2	Seat	Stainless steel
3	O-ring	NBR (Nitrile)
4	Stirrup	Brass
5	Seal	NBR (Nitrile)
6	Seal box	Brass
7	Membrane	NBR/Polyamide
8	Membrane washer	Brass
9	Copper washer	Copper
10	Membrane screw	Stainless steel
11	Nut for spring pressing	Brass
12	Adjusting screw	Brass
13	Spring	Anticorrosive steel
14	Cap	Brass
15	Screw	Stainless steel
16	Cap cover	Brass
17	O-ring	NBR (Nitrile)
18	Pressure gauge cap	Brass
19	Flat seal	NBR (Nitrile)
20	Compensating spring	Stainless steel

Technical description

- **Connection** : female/female, BSP thread
- **Downstream pressure gauge** : 1/4"
- **Permissible operating pressure**
PFA - water : See table
- **Maximum permissible pressure**
PS - other medium : See table
- **T°** : Mini. -10°C
Maxi. in permanent service 80°C (40°C domestic fuel oil)
- **Mediums** : water, air-neutral gas, domestic fuel oil
- **Approvals** : NF - ACS (France)
- **International construction**
Standards :
Pressure reducing valves EN 1567 /
Threaded connec. NF EN ISO 228

Technical table

DN	D		A	B	C	E	Kg
mm	mm	inch	mm	mm	mm	mm	
15	15/21	1/2	31	60	59	66	0.7
20	20/27	3/4	32	75	73	76.5	0.9
25	36/34	1	40	102	94	98	1.9
32	33/42	1 1/4	51	179	104	126	3.9
40	40/49	1 1/2	46	185	104	132	4.2
50	50/60	2	54	194	104	146	5.2

Pressure setting range

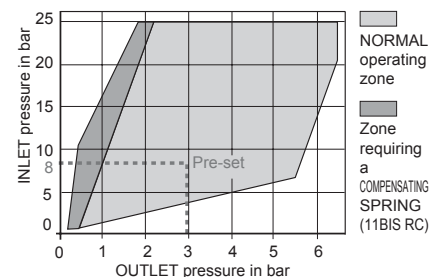

Flow - m³/h

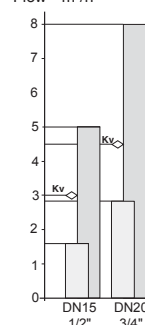

Flow (Type 11BIS)

- Flow at the velocity used in the Standard (2 m/s)
- Maximum flow (0 outlet pressure) under an upstream pressure of 8 bar

- **Acoustic level.** The standardised DS the expresses the differential between standard (noise generator) and its value measured in dB(A). The higher the DS is, the quieter the machine/apparatus will be.

Standardised DS value as per NF-S-31016

1/2" DS 10 (at 0.18 l/s)
3/4" DS 16 (at 0.32 l/s)

*last updated 03/16