



TECHNO

Magnetic pump 【QHX series】

Product characteristics

1. The magnetic pump adopts the non-shaft-seal design, and the pump is completely sealed without leakage;
2. Equipped with anti idling device, so that the magnetic pump will not be damaged in case of no water idling for a long time, and improve the durability of the product;
3. The new design of flow passage can minimize the loss of products and improve the use efficiency
- 4 The applicable temperature shall be determined according to different chemical properties: GFRPP - below 80 °C, CFRPP - below 80 °C, PVDF - below 100 °C, CFRETFE - below 150 °C.

Product superiority

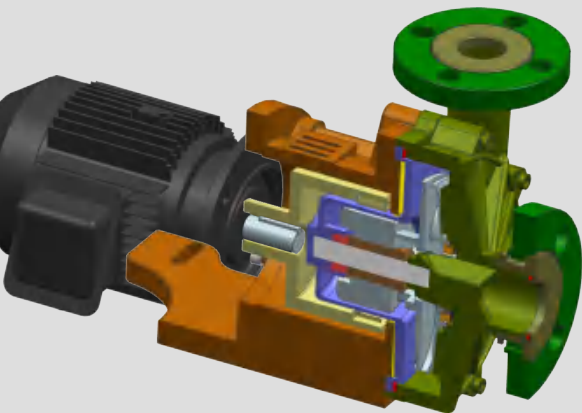

1. A variety of connection modes of front cover inlet and outlet are available;
2. The front and rear covers adopt convex point structure and flat gasket sealing ring to ensure excellent sealing effect;
3. Impeller deflection is lower than 0.2mm;
4. Passive magnets and plastic shells are injection molded at one time to ensure that there is no penetration forever.
5. The shaft core is made of 99% alumina and SSIC material;
6. The gasket of the back cover is made of SUS304 material to enhance its temperature resistance and pressure resistance;
7. The connection between the motor and the pump head is a plastic injection molding integrated structure, which can prevent the corrosion of the connection caused by the leakage of acid and alkali gas and liquid;
8. The surface of drive magnet adopts resin paint baking, with better corrosion resistance. After dynamic balance test, the vibration of drive magnet is lower than 2.0mm/s;
9. The motor adopts international brand, with stable performance and ultra-quiet operation.