

# APL



## APPLICATIONS

- Drainage in the digestion tank
- Waste water, Sump drainage
- Drainage of spring water and stagnant water in the construction field
- Dewatering for fish pond or basement and cellars

## SPECIFICATION

Pumping liquid	Disc.diameter(mm)	50 · 80 · 100	
	Liquid temp	0~40°C	
	Liquid nature	Waste water	
Pump	Max.depth	30M	
	Structure	Impeller	Semi-open & enclosed channel [100APL-52.2(S)]
		Mech. seal	Double mechanical seals
		Bearing	Ball type bearing
	Material	Upper cover	FC200
		Impeller	FC200 (50APL-5.4(S):PA)
		Casing	FC200
		Casing cover	FC200
	Motor	Mech. seal	CA/CE & SIC/SIC
		Type	Dry type
Insulation		B class	
Frequency · Pole		50Hz · 2P	
Protector		Auto-cut (50APL-5.4S: Overheat protector)	
Material		Frame	SUS304
	Main shaft	0.4 ~ 1.1kW : SUS410 1.5 ~ 3.7kW : SUS403	
	Cable	VCT	
Optional		Float switch Auto setter	

## FEATURES

- A precisely manufactured motor is achieved utilizing the highest standard of quality control. To ensure 100% quality manufactured motor with stable performance and highest efficiency, All rotors adopt heat treatment method for drive shaft assembling and stator winding impregnated with varnish and baked in industrial oven.
- Standard accessories include: VCT cable with an epoxy resin sealed water resistant cable base, Auto Cut motor thermal protector, double mechanical seals and lip seal design.

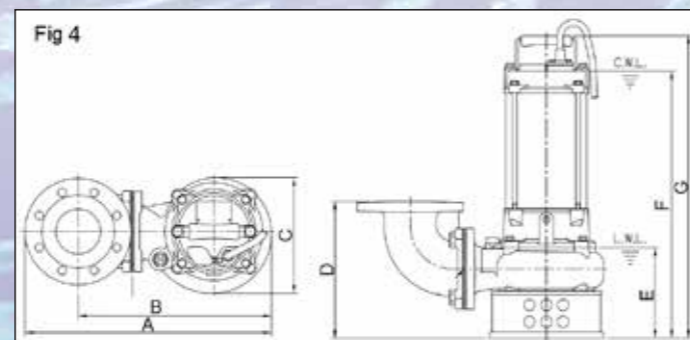

## SELECTION CHART

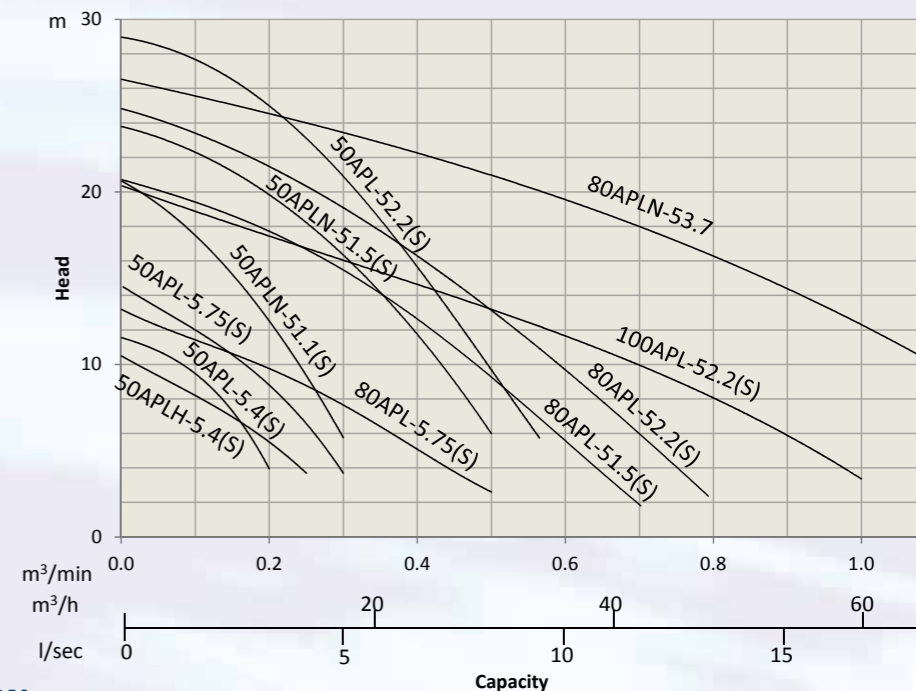

## PERFORMANCE SPECIFICATION

Pole P	Impeller Type	Dis. mm	Output kW	Phase φ	Start Method	Model	Capacity m³/min	Head m	Solid passage mm	Weight kg	
2	Semi-open	50	0.4	1	Capacitor	50APL-5.4S	0.1	8	7.5	13	
				3	Direct	50APL-5.4	1	8	7.5	12	
			0.75	1	Capacitor	50APLH-5.4S	0.15	7	10	16	
				3	Direct	50APLH-5.4	0.15	7	10	14	
			1.1	1	Capacitor	50APL-5.75S	0.18	10	10	17	
				3	Direct	50APL-5.75	0.18	10	10	15	
			1.5	1	Capacitor	50APLN-51.1S	0.16	15	7	20	
				3	Direct	50APLN-51.1	0.16	15	7	18	
			2.2	1	Capacitor	50APLN-51.5S	0.25	18.5	10.5	31	
				3	Direct	50APLN-51.5	0.25	18.5	10.5	27	
			80	0.75	1	Capacitor	50APL-52.2S	0.2	24.5	10.5	38
					3	Direct	50APL-52.2	0.2	24.5	10.5	32
		1.5		1	Capacitor	80APL-5.75S	0.3	6.5	10	18	
				3	Direct	80APL-5.75	0.3	6.5	10	17	
		2.2		1	Capacitor	80APL-51.5S	0.4	12	10.5	37	
				3	Direct	80APL-51.5	0.4	12	10.5	32	
		3.7		1	Capacitor	80APL-52.2S	0.4	16	10.5	39	
				3	Direct	80APL-52.2	0.4	16	10.5	33	
		Enclosed		100	1	Capacitor	80APLN-53.7	0.6	18.5	20	35
					3	Direct	80APLN-53.7	0.6	18.5	20	35
		100		2.2	1	Capacitor	100APL-52.2S	0.7	10	10.5	40
					3	Direct	100APL-52.2	0.7	10	10.5	35

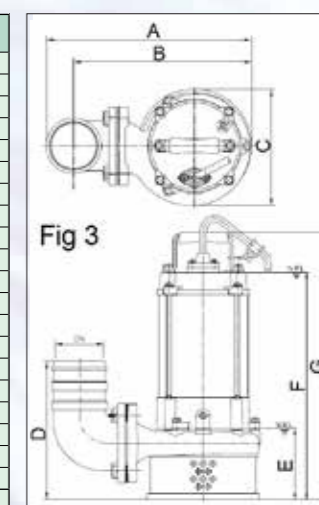

## DIMENSIONS

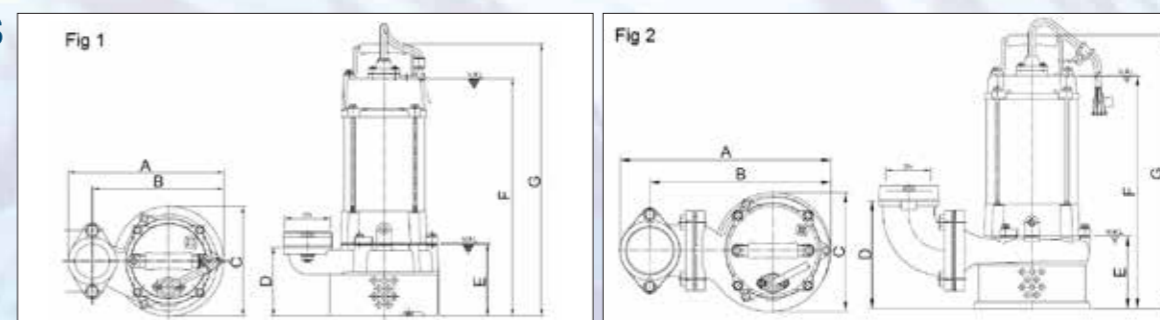

MODEL	Fig	DN	A	B	C	D	E	F	G	CABLE LENGTH
50APL-5.4(S)	1	PF	225	190	161	86	88	316	371	5000
50APLH-5.4(S)	1	PF	245	207	173	109	100	373	428	5000
50APL-5.75(S)	1	PF	245	207	173	109	100	373	428	5000
50APLN-51.1S	1	PT	262	224	187	91	90	373	428	8000
50APLN-51.1	1	PT	262	224	187	91	90	353	408	8000
50APLN-51.5S	1	PF	282	244	207	138	141	517	580	8000
50APLN-51.5	1	PF	282	244	207	138	141	436	499	8000
50APL-52.2S	1	PF	279	241	209	126	130	497	561	5000
50APL-52.2	1	PF	279	241	209	126	130	419	482	5000
80APL-5.75(S)	1	PF	278	224	173	135	130	402	456	5000
80APL-51.5S	2	PT	388	333	216	200	132	500	563	8000
80APL-51.5	2	PT	388	333	216	200	132	422	485	8000
80APL-52.2S	2	PT	388	333	216	200	132	500	563	8000
80APL-52.2	2	PT	388	333	216	200	132	422	485	8000
80APLN-53.7	4	PT	440	346	207	244	162	477	540	8000
100APL-52.2S	3	100	384	333	216	256	130	500	563	8000
100APL-52.2	3	100	384	333	216	256	130	422	485	8000